

Oaklands Holiday Park
St. Osyth
CO16 8HW
£69,995 Leasehold



9 Osbornes Court, Victoria Place, Brightlingsea, Essex CO7 0EB 01206 302288
www.townandcountryresidential.co.uk



- RARE LAKEFRONT LUXURY LODGE
- LARGE CORNER PLOT
- PRINCIPAL BEDROOM WITH EN-SUITE
- SECOND BEDROOM WITH WALK-IN WARDROBE

- LOUNGE OVERLOOKS THE LAKE
- FAMILY BATHROOM
- PARKING FOR UP TO THREE VEHICLES
- WRAP AROUND DECKING OVERLOOKING THE LAKE
- AVAILABLE FOR 50 WEEKS OF THE YEAR

**** RARE LAKEFRONT LODGE on a LARGE CORNER PLOT ****

This 2010 Willerby Boston 40 x 20 is a two bedroom luxury lodge with spacious open plan kitchen/diner with the lounge area looking out over the lake. There are two double bedrooms, the principal features an En-suite shower room and dressing area, the second has a large walk-in wardrobe.

The main bathroom houses a bath with shower over, vanity unit and low level WC. There is a copious amount of storage inside the lodge which is a great addition.

Outside, there is parking for up to three vehicles, a grassed area and a wrap around veranda which looks out over the lake where you can sit and relax whilst watching the sun setting.

Oaklands Holiday Park is open 50 weeks of the year and features a fabulous bar/club house which hosts events throughout the season, a well stocked convenience store and is ideally located for countryside walks and just a short drive to the beach



The accommodation with approximate room sizes are as follows:

LOUNGE/DINER/KITCHEN

21' 9" x 19' 7" (6.62m x 5.96m)

Doors to side and decking, windows to side and front, grey laminate flooring, centre lights, dining area, three radiators. Range of wall and base units incorporating slim-line dishwasher, fridge/freezer, eye level double oven, microwave, five ring gas hob, stainless steel sink/drainer, space for washing machine, storage cupboard.

BEDROOM ONE

9' 7" x 9' 3" (2.92m x 2.82m)

Window to side, carpet flooring, centre light, radiator.

EN-SUITE

5' 7" x 5' 0" (1.70m x 1.52m)

Obscured window to side, grey laminate flooring, centre light, radiator, shower cubicle, low level WC and vanity unit.

DRESSING AREA

5' 8" x 4' 7" (1.73m x 1.40m)

Carpet flooring, double fitted wardrobe.

BEDROOM TWO

9' 8" x 9' 1" (2.94m x 2.77m)

Window to side, carpet flooring, centre light, radiator, walk-in fitted wardrobe (6'7" x 3'11"), heater.

FAMILY BATHROOM

6' 9" x 5' 6" (2.06m x 1.68m)

Obscured window to side, grey laminate flooring, centre light, radiator. Panelled bath with shower over, low level WC and vanity unit.

EXTERIOR

Parking for up to three vehicles, grassed area, Asgard metal storage cupboard with power, wrap around veranda with side rail overlooking the lake, skirting with under lodge storage.





GROUND FLOOR
816 sq.ft. (75.8 sq.m.) approx.

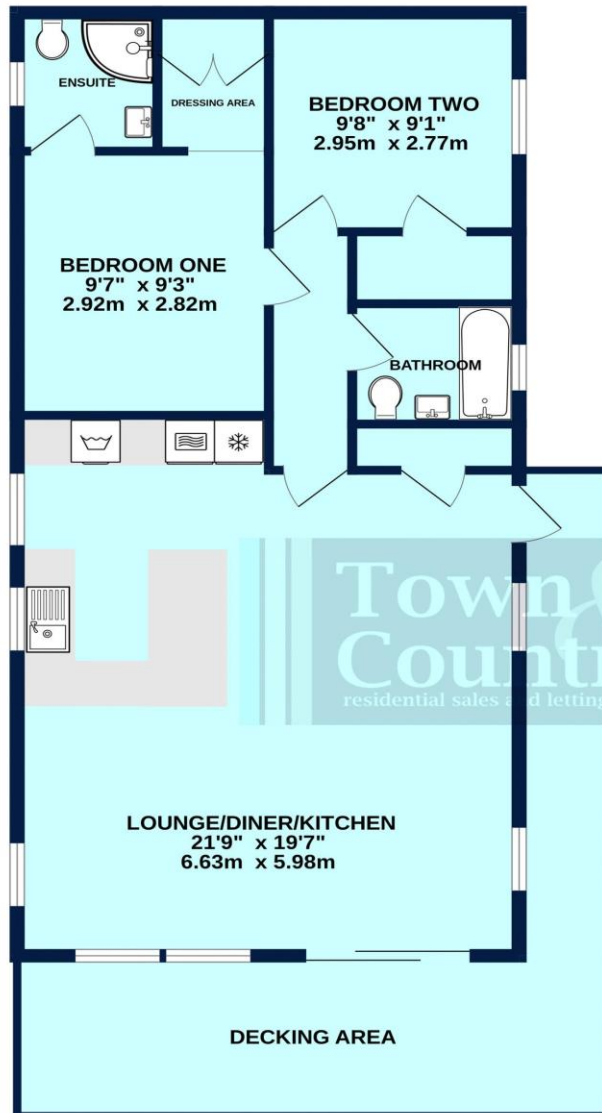

LAKESIDE

TOTAL FLOOR AREA : 816 sq.ft. (75.8 sq.m.) approx.

Whilst every attempt has been made to ensure the accuracy of the floorplan contained here, measurements of doors, windows, rooms and any other items are approximate and no responsibility is taken for any error, omission or mis-statement. This plan is for illustrative purposes only and should be used as such by any prospective purchaser. The services, systems and appliances shown have not been tested and no guarantee as to their operability or efficiency can be given.
Made with Metropix ©2024

Property Misdescription Act 1991: The Agent has not tested any apparatus, equipment, fixture, fittings or services and does not verify they are in working order, fit for their purpose, or within ownership of the sellers, or within the lessors interest therefore the buyer or ingoing tenant must assume the information given is incorrect. All sizes are approx. and should not be relied on. Buyers/ tenants should satisfy themselves of dimensions when ordering inward fixtures and fittings. Neither has the agent checked the legal documentation to verify legal status of the property, or any neighbourhood planning that is pending, current or proposed for the future. A buyer or ingoing tenant must assume the information is incorrect until it has been verified by their own solicitors. Nothing concerning the type of construction, condition of the structure or its surroundings is to be implied from the photograph, artist's

9 Osbornes Court, Victoria Place, Brightlingsea, Essex CO7 0EB 01206 302288

www.townandcountryresidential.co.uk